

قرار وزير البلدية والبيئة رقم (٢٦٥) لسنة ٢٠١٩

باعتبار استملاك العقارات اللازمة لصالح مشروع تطوير طريق الوكير

من أعمال المنفعة العامة

وزير البلدية والبيئة ،

بعد الاطلاع على القانون رقم (١٣) لسنة ١٩٨٨ ، بشأن نزع ملكية بعض العقارات والاستيلاء عليها مؤقتاً للمنفعة العامة ، وتعديلاته ،

وعلى القرار الأميري رقم (١٦) لسنة ٢٠١٤ ، بتعيين اختصاصات الوزارات ، وتعديلاته ،

وعلى القرار الأميري رقم (١١) لسنة ٢٠١٩ ، بشأن الهيكل التنظيمي لوزارة البلدية والبيئة ،

وعلى قرار مجلس الوزراء الموقر في اجتماعه العادي (٣٤) لسنة ٢٠١٩ المنعقد بتاريخ ٢٠١٩/١٠/٣٠ ،

وعلى إقتراح مدير إدارة نزع الملكية ،

قرر ما يلي :

مادة (١)

يُعتبر من أعمال المنفعة العامة استملاك العقارات اللازمة لصالح مشروع تطوير طريق الوكير ، والموضحة تفاصيلها وموقعها بالمذكرة والمخطط التوجيهي المرفقين بهذا القرار .

مادة (٢)

تتعين حدود ومعالم العقارات المراد نزع ملكيتها بما تضمنه الرسم التخطيطي المرفق .

مادة (٣)

على جميع الجهات المختصة ، كل فيما يخصه ، تنفيذ هذا القرار ، ويُعمل به من تاريخ صدوره وينشر في الجريدة الرسمية .

عبدالله بن عبدالعزيز بن تركي السبيعي
وزير البلدية والبيئة

صدر بتاريخ : ٢٥ / ١١ / ٢٠١٩ م

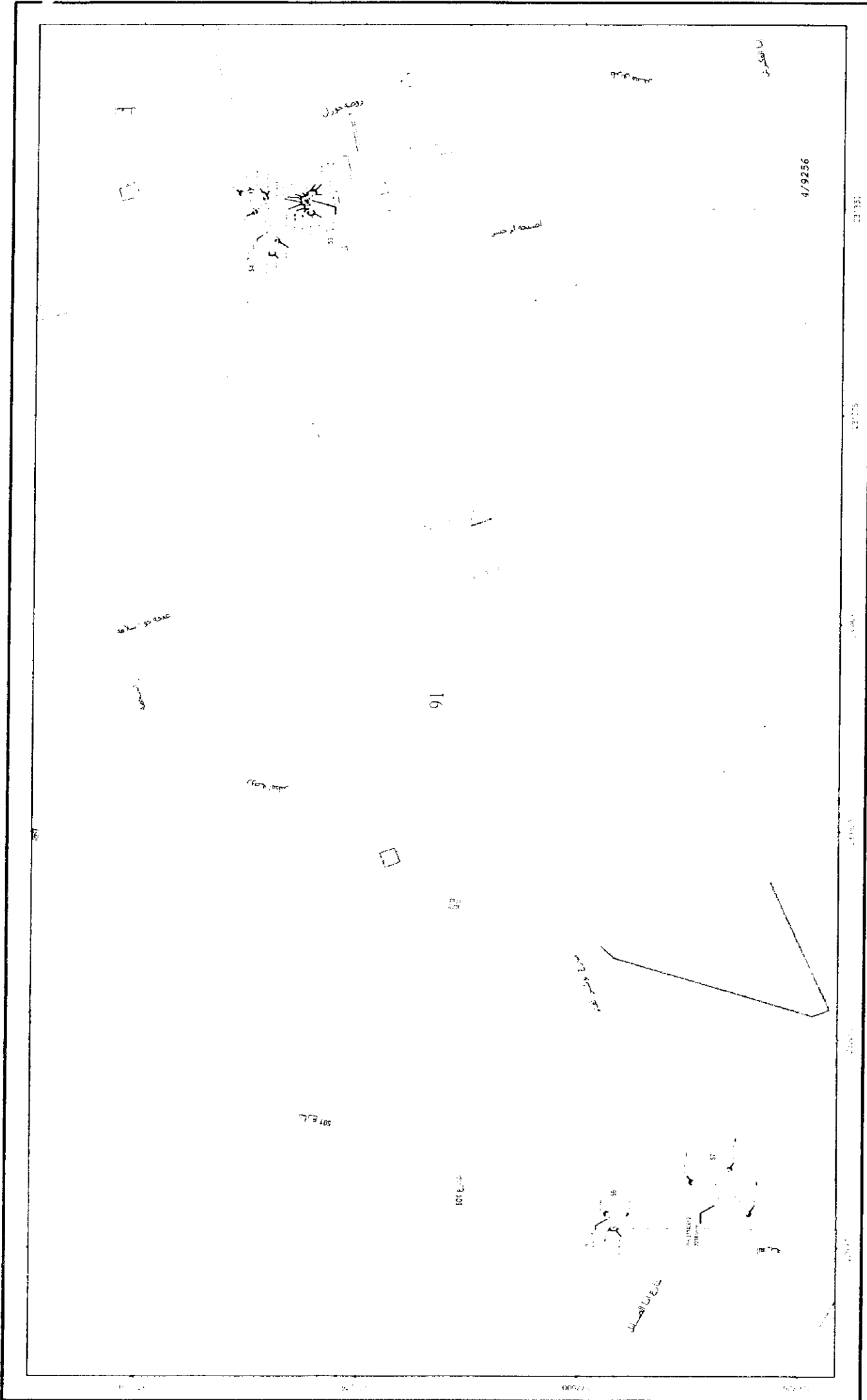

NOTE

Scale 1:5000

QATAR NATIONAL GRID

Transverse Mercator
International Hayford
51 13' E 200,000 E
24 27' N 300,000 N
meters



Date: 10/10/2019 3:35 PM
Emp Id: 9256
Department: LAND ACQUISITION

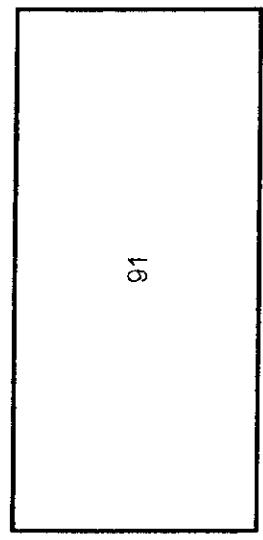



NOTE

Scale 1:5000

QATAR NATIONAL GRID

Transverse Mercator
International Hayford
51 13' E 200,000 E
24 27' N 300,000 N
meters

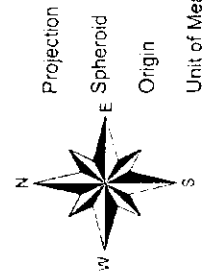

Projection
E Spheroid
Origin
Unit of Measurement



وزارة البلدية والبيئة
دولة قطر
Lands & Survey Department

Date: 10 /10/2019 3:35 PM
Emp Id: 9256
Department: LAND ACQUISITION

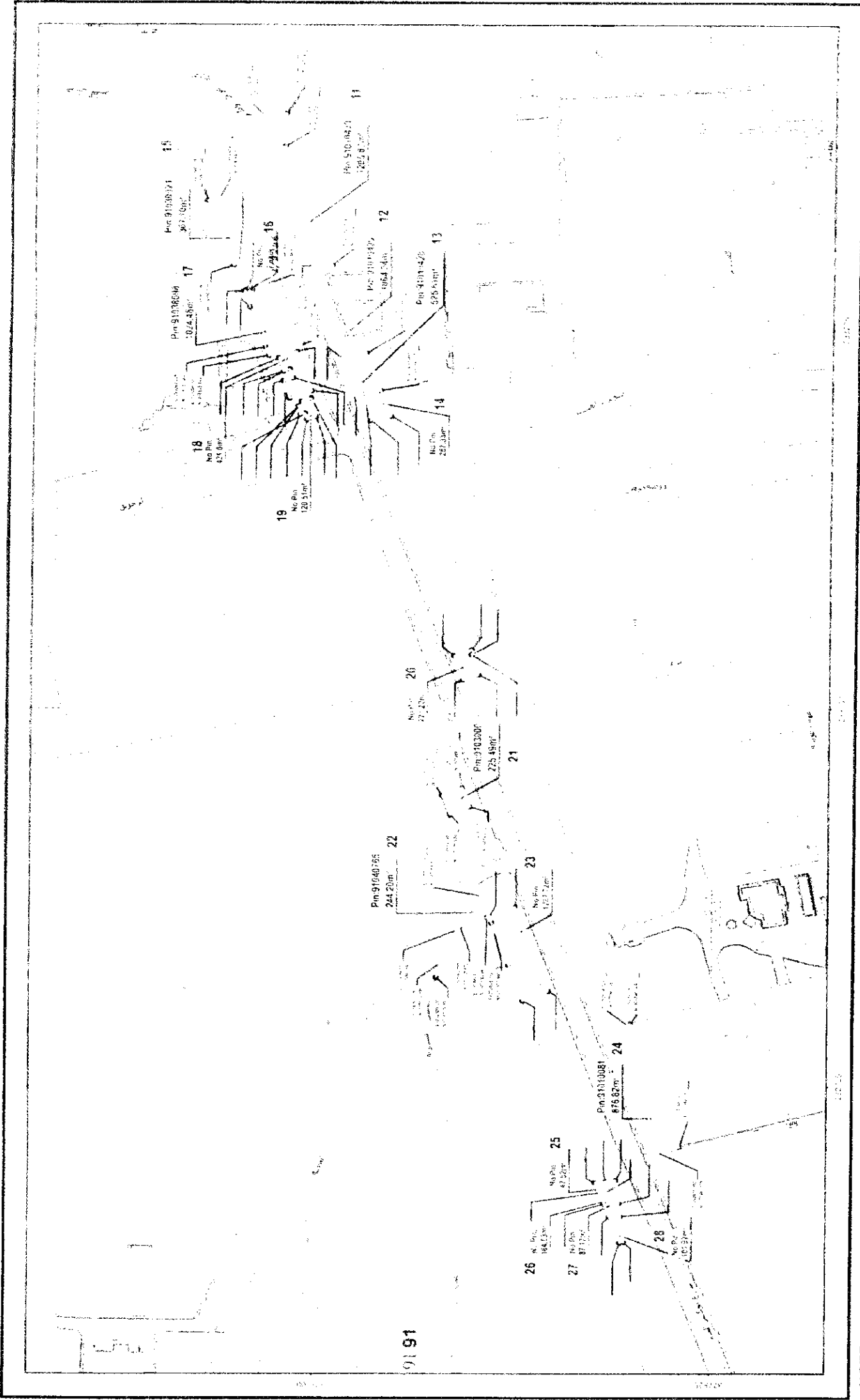

NOTE

Scale 1:2750

QATAR NATIONAL GRID

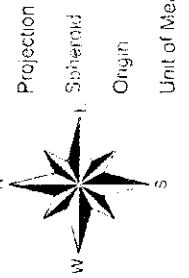

Projection
Transverse Mercator
Spheroid
International Hayford
Origin
51 13' E 200,000 E
24 27' N 300,000 N
Unit of Measurement
meters

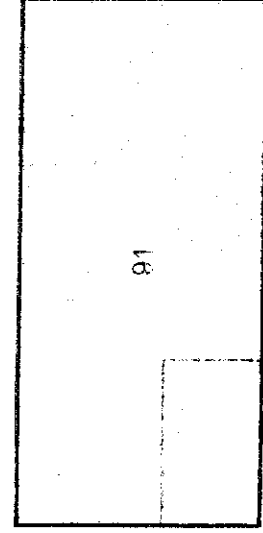

Date
10/10/2015
Emp. Id:
9255
Department:
LAND ACQUISITION

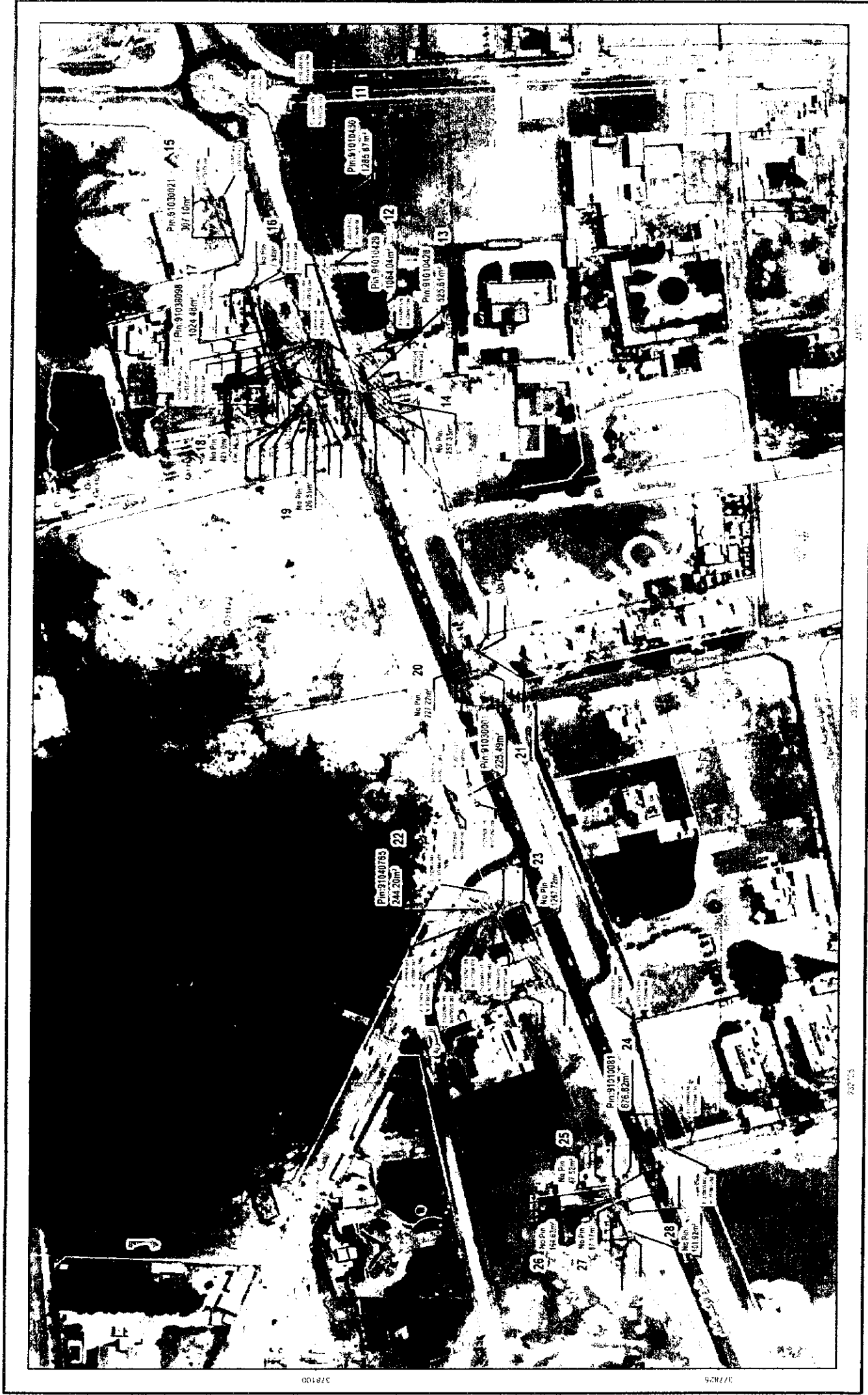

NOTE



Land & Survey Department

Date: 10/16/2019 2:24 PM
 Emp. Id: 9256
 Department: LAND ACQUISITION

91

Scale 1:2750

QATAR NATIONAL GRID

Projection: Spheroid
 Origin: E 200,000.00, N 300,000.00
 Unit of Measurement: meters

Transverse Mercator
 International Hayford
 51 13' E 200,000 E
 24 27' N 300,000 N
 meters

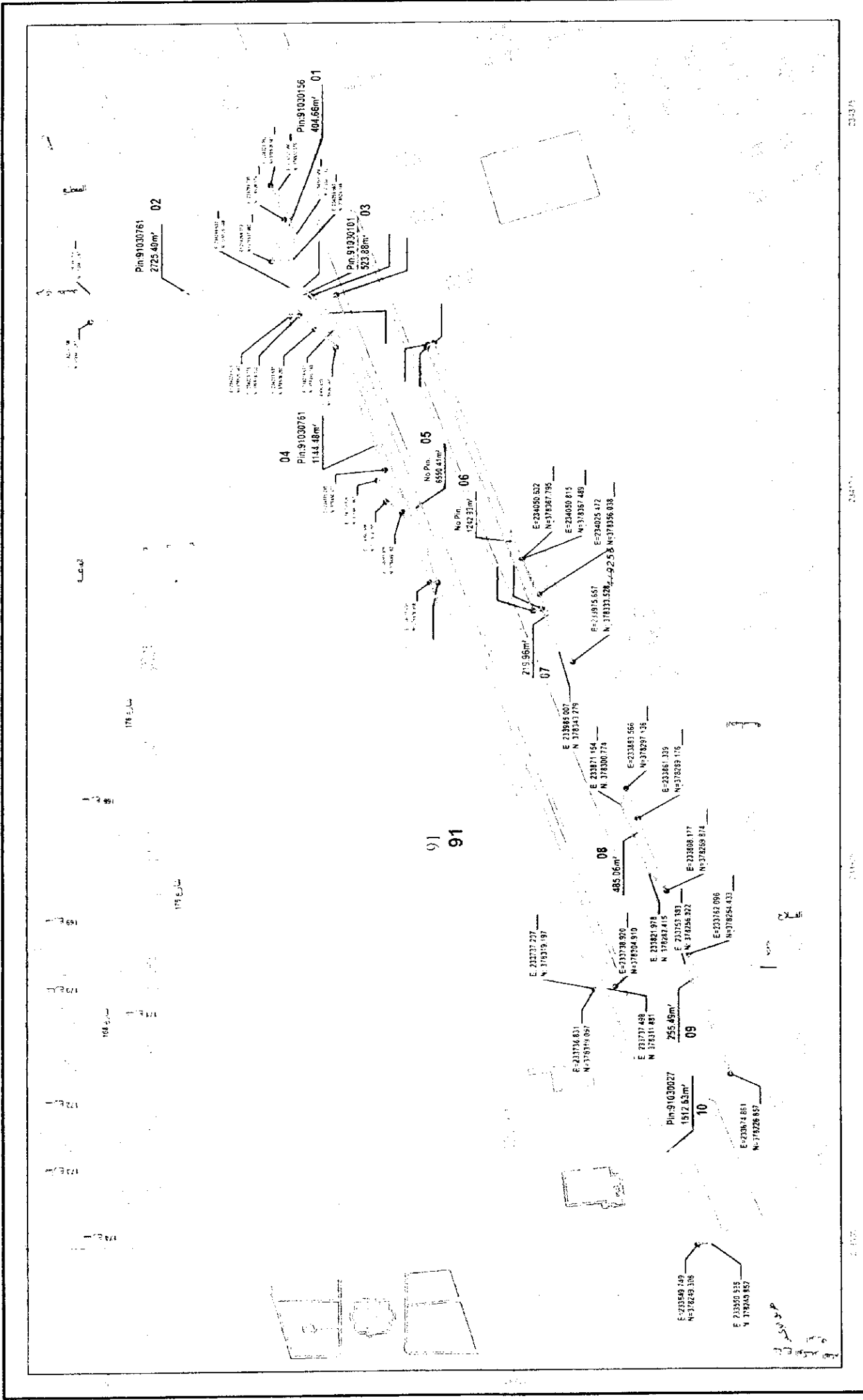

NOTE

Scale 1:2750

QATAR NATIONAL GRID

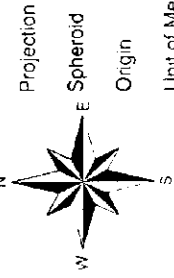

Projection
Spheroid
Origin
Unit of Measurement
meters



وزارة البلدية والبيئة
MINISTRY OF MUNICIPALITY & ENVIRONMENT
مركز المساحة والقياس
Lands & Survey Department

Date: 10/10/2019 12:22 PM

Emp Id: 9256

Department

LAND ACQUISITION

PlanMap Ver 10.3

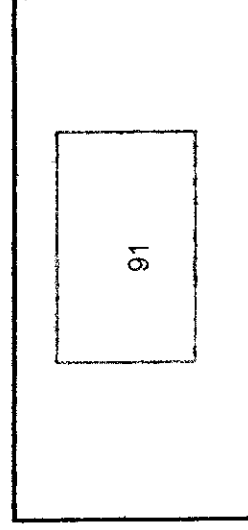

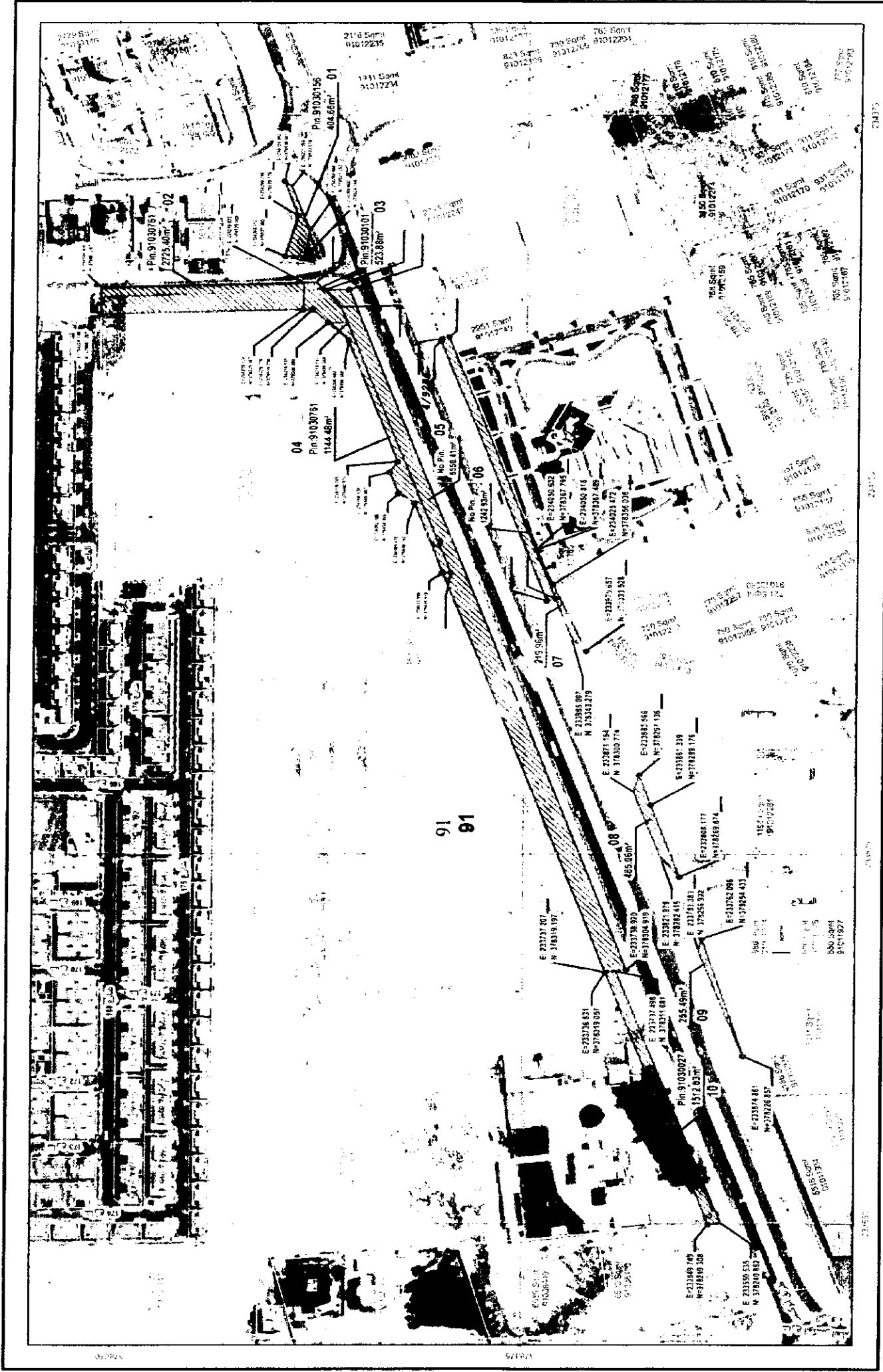

NOTE

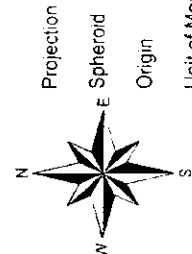

Projection
E Spheroid
Origin
Unit of Measurement
meters

Scale 1:2750

QATAR NATIONAL GRID

Transverse Mercator
International Hayford
51 13' E 200,000 E
24 27' N 300,000 N

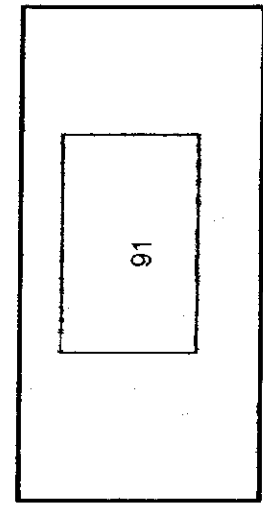

وزارة البلدية والبيئة
Ministry of Municipality & Environment
Land & Survey Department

Date: 10/10/2019 2:1 PM
Emp Id: 9256
Department: LAND ACQUISITION

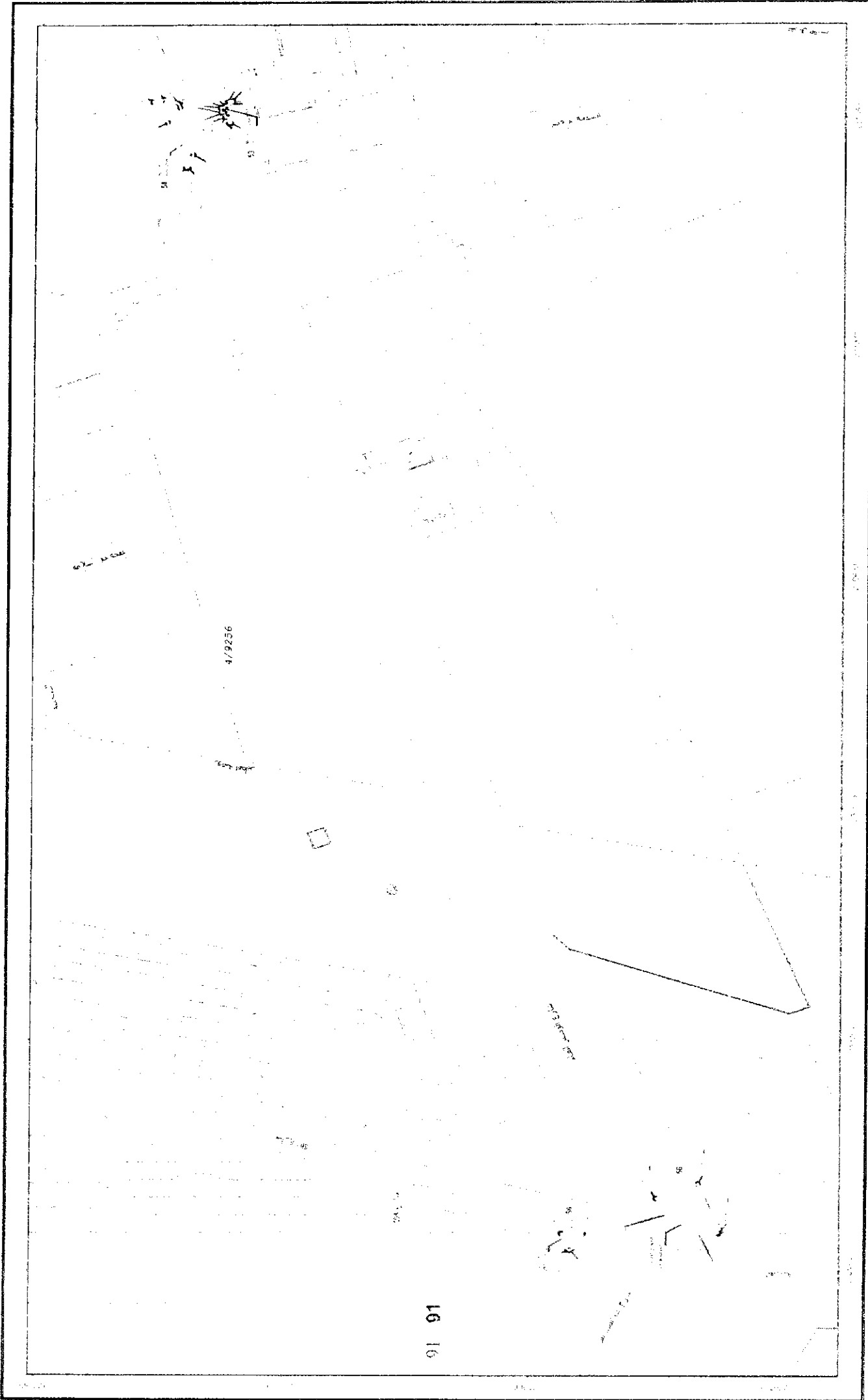

NOTE

Scale 1:4500

QATAR NATIONAL GRID

Projection
Transverse-Mercator
International Hayford
51 13' E 200,000 F
24 27' N 300,000 N
Unit of Measurement
meters

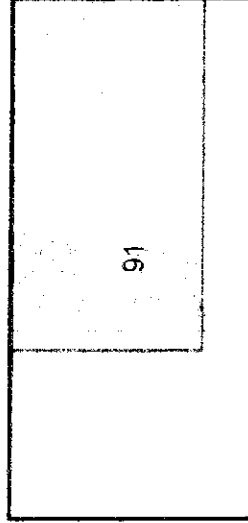
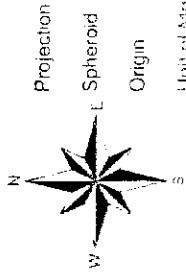

Date: 10-10-2019 1:09 PM
Emp Id: 9256
Department: LAND ACQUISITION



NOTE

Scale 1:4500

QATAR NATIONAL GRID

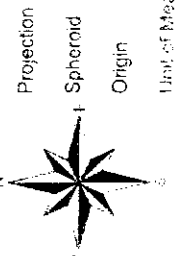

Projection
Spheroid
Origin
Unit of Measurement

Transverse Mercator
International Hayford
64 13' E 200 000 E
24 27' N 300 000 N
meters



Date 10/10/2019 1:08 PM
Emp Id 9256
Department LAND ACQUISITION

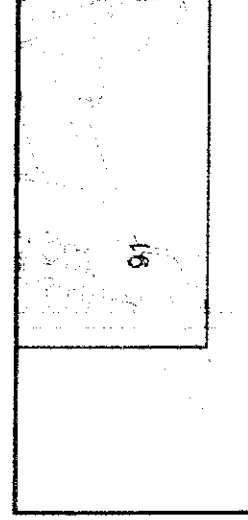

ازالة التعدييات عن حرم الطريق المعتمد - شارع الوكير

01		
Pnts	COORDINATES	
	EAST	NORTH
1	234269.312	378537.980
2	234299.795	378529.176
3	234324.992	378538.581
4	234324.050	378533.578
5	234288.608	378521.252
6	234269.660	378524.148

02		
Pnts	COORDINATES	
	EAST	NORTH
1	234226.198	378661.267
2	234246.205	378661.267
3	234249.632	378525.048
4	234229.624	378525.047

03		
Pnts	COORDINATES	
	EAST	NORTH
1	234249.632	378525.048
2	234249.843	378516.617
3	234231.398	378499.518
4	234219.632	378495.048
5	234219.631	378508.280
6	234229.776	378519.030
7	234229.624	378525.047

04		
Pnts	COORDINATES	
	EAST	NORTH
1	234219.631	378508.280
2	234219.632	378495.048
3	234033.987	378424.520
4	234033.856	378429.918
5	234085.415	378449.162
6	234092.686	378459.955
7	234108.526	378465.867
8	234116.245	378460.670

05

Pnts	COORDINATES	
	EAST	NORTH
1	234243.920	378511.126
2	234244.572	378493.959
3	233738.920	378304.910
4	233737.498	378311.881
5	233737.207	378319.197
6	234033.856	378429.918
7	234033.987	378424.520
8	234231.398	378499.518

06

Pnts	COORDINATES	
	EAST	NORTH
1	234205.876	378432.183
2	234207.895	378431.202
3	234208.996	378426.902
4	234014.841	378354.417
5	234013.314	378360.216

07

Pnts	COORDINATES	
	EAST	NORTH
1	234050.632	378367.795
2	234050.815	378367.489
3	234025.472	378356.038
4	233975.657	378333.528
5	233985.007	378343.279

08

Pnts	COORDINATES	
	EAST	NORTH
1	233871.154	378300.774
2	233883.566	378297.136
3	233861.339	378289.176
4	233808.177	378269.874
5	233821.978	378282.415

09

Pnts	COORDINATES	
	EAST	NORTH
1	233753.383	378256.922
2	233762.096	378254.433
3	233674.861	378226.857

10

Pnts	COORDINATES	
	EAST	NORTH
1	233736.831	378319.057
2	233737.498	378311.881
3	233550.535	378240.852
4	233549.749	378249.308

13

Pnts	COORDINATES	
	EAST	NORTH
1	233254.179	378084.322
2	233257.878	378067.199
3	233230.749	378056.812
4	233226.832	378075.614

11

Pnts	COORDINATES	
	EAST	NORTH
1	233430.981	378140.623
2	233432.031	378124.299
3	233804.109	378124.719
4	233321.612	378091.601
5	233320.860	378105.556

14

Pnts	COORDINATES	
	EAST	NORTH
1	233228.541	378067.629
2	233230.749	378056.812
3	233211.756	378049.472
4	233208.746	378063.672

12

Pnts	COORDINATES	
	EAST	NORTH
1	233320.860	378105.556
2	233321.612	378091.601
3	233257.878	378067.199
4	233254.179	378084.322

15

Pnts	COORDINATES	
	EAST	NORTH
1	233368.665	378178.148
2	233370.964	378169.629
3	233322.461	378156.812
4	233321.581	378160.118

16

Pnts	COORDINATES	
	EAST	NORTH
1	233302.943	378152.981
2	233303.280	378151.727
3	233322.461	378156.812
4	233291.393	378148.557

17

Pnts	COORDINATES	
	EAST	NORTH
1	233262.525	378137.507
2	233304.700	378146.438
3	233263.583	378113.351
4	233256.357	378135.145

18

Pnts	COORDINATES	
	EAST	NORTH
1	233254.415	378128.450
2	233259.279	378115.598
3	233230.577	378104.978
4	233225.034	378120.464
5	233237.946	378124.790
6	233246.415	378120.694
7	233244.965	378124.718

19

Pnts	COORDINATES	
	EAST	NORTH
1	233222.923	378112.109
2	233225.200	378105.417
3	233211.358	378101.737
4	233209.381	378108.246
5	233213.902	378109.523
6	233213.029	378113.091
7	233219.108	378114.655

20

Pnts	COORDINATES	
	EAST	NORTH
1	233038.728	378004.760
2	233042.901	377991.947
3	233040.041	377990.815
4	233039.506	377992.448
5	233024.613	377987.350
6	233020.859	377998.338

21

Pnts	COORDINATES	
	EAST	NORTH
1	232936.582	378012.083
2	232942.129	377998.146
3	232928.216	377992.539
4	232922.645	378006.536

22

Pnts	COORDINATES	
	EAST	NORTH
1	232863.541	377984.970
2	232848.016	377978.979
3	232844.019	377977.446
4	232848.017	377980.441
5	232841.288	377998.870
6	232804.361	378015.381
7	232814.259	378012.986
8	232838.408	378001.847

23

Pnts	COORDINATES	
	EAST	NORTH
1	232848.016	377978.979
2	232855.503	377960.979
3	232794.129	377937.635
4	232787.270	377955.520

24

Pnts	COORDINATES	
	EAST	NORTH
1	232769.701	377883.082
2	232770.437	377880.544
3	232680.516	377846.103
4	232676.503	377861.259

25

Pnts	COORDINATES	
	EAST	NORTH
1	232653.523	377904.298
2	232654.361	377897.273
3	232646.119	377896.767
4	232645.868	377901.366

26

Pnts	COORDINATES	
	EAST	NORTH
1	232646.119	377896.767
2	232654.361	377897.273
3	232655.253	377890.028
4	232637.441	377887.780
5	232637.400	377898.123
6	232645.868	377901.366

27

Pnts	COORDINATES	
	EAST	NORTH
1	232637.400	377898.123
2	232637.441	377887.780
3	232627.909	377886.604
4	232627.633	377894.382

28

Pnts	COORDINATES	
	EAST	NORTH
1	232627.633	377894.382
2	232627.909	377886.604
3	232608.858	377884.287
4	232608.479	377887.047

29

Pnts	COORDINATES	
	EAST	NORTH
1	232453.711	377827.829
2	232456.212	377813.183
3	232438.033	377810.010
4	232436.328	377821.121

30

Pnts	COORDINATES	
	EAST	NORTH
1	232434.998	377829.017
2	232443.792	377823.983
3	232436.328	377821.121

31

Pnts	COORDINATES	
	EAST	NORTH
1	232414.809	377821.291
2	232417.750	377803.835
3	232410.045	377790.472
4	232367.999	377774.344
5	232367.228	377778.603
6	232365.803	377778.449
7	232362.991	377793.046
8	232384.072	377800.988
9	232384.052	377801.110
10	232408.668	377810.536

32

Pnts	COORDINATES	
	EAST	NORTH
1	232362.991	377793.046
2	232365.803	377778.449
3	232367.228	377778.603
4	232367.999	377774.344
5	232346.594	377769.974
6	232343.055	377789.119
7	232344.156	377789.329
8	232347.882	377787.258

Tag	33	
Pnts	COORDINATES	
	EAST	NORTH
1	232315.728	377729.58
2	232281.279	377716.709
3	232270.443	377704.517
4	232271.697	377679.671
5	232275.254	377679.809
6	232275.254	377679.809
7	232318.388	377707.428

Tag	34	
Pnts	COORDINATES	
	EAST	NORTH
1	232260.067	377681.971
2	232237.767	377682.047
3	232238.049	377676.548
4	232238.556	377676.213
5	232252.257	377667.149
6	232253.461	377641.246
7	232262.375	377641.537

Tag	35	
Pnts	COORDINATES	
	EAST	NORTH
1	232193.713	377728.256
2	232034.845	377669.406
3	232035.963	377650.615
4	232185.831	377706.646
5	232194.708	377716.128

Tag	36	
Pnts	COORDINATES	
	EAST	NORTH
1	232141.140	377653.370
2	232108.606	377649.604
3	232108.606	377629.962
4	232111.190	377630.030
5	232142.359	377641.599

Tag	37	
Pnts	COORDINATES	
	EAST	NORTH
1	232108.606	377649.604
2	232093.763	377648.090
3	232094.101	377644.499
4	232074.424	377637.241
5	232067.505	377636.395
6	232069.081	377622.753
7	232063.999	377622.102
8	232065.584	377613.102
9	232108.606	377629.071

Tag	38	
Pnts	COORDINATES	
	EAST	NORTH
1	232043.018	377627.629
2	232014.834	377615.792
3	232018.960	377595.797
4	232045.765	377605.746

Tag	39	
Pnts	COORDINATES	
	EAST	NORTH
1	232013.109	377615.126
2	231976.847	377599.520
3	231979.094	377583.447
4	231978.157	377583.280
5	231978.564	377580.803
6	232017.112	377595.111

Tag	41	
Pnts	COORDINATES	
	EAST	NORTH
1	231943.811	377580.665
2	231932.274	377579.161
3	231932.248	377579.446
4	231900.639	377575.823
5	231903.372	377551.912
6	231921.456	377558.722
7	231921.873	377555.554
8	231925.715	377561.187
9	231945.565	377568.555

Tag	40	
Pnts	COORDINATES	
	EAST	NORTH
1	231976.062	377602.596
2	231942.513	377590.053
3	231945.565	377568.555
4	231978.564	377580.803
5	231978.157	377583.280
6	231979.094	377583.447
7	231976.847	377599.520

Tag	42	
Pnts	COORDINATES	
	EAST	NORTH
1	231921.456	377558.722
2	231903.372	377551.912
3	231914.661	377545.239
4	231921.873	377555.554

Tag	43	
Pnts	COORDINATES	
	EAST	NORTH
1	231923.409	377543.892
2	231916.459	377544.173
3	231918.812	377542.778

Tag	44	
Pnts	COORDINATES	
	EAST	NORTH
1	231870.455	377550.448
2	231848.898	377550.828
3	231848.257	377531.781
4	231870.228	377540.138

Tag	47	
Pnts	COORDINATES	
	EAST	NORTH
1	231825.044	377590.957
2	231800.234	377581.553
3	231802.752	377562.798
4	231829.395	377582.471

Tag	45	
Pnts	COORDINATES	
	EAST	NORTH
1	231886.464	377604.568
2	231860.943	377603.183
3	231861.040	377601.146
4	231843.034	377599.411
5	231868.798	377655.748
6	231886.933	377593.631

Tag	48	
Pnts	COORDINATES	
	EAST	NORTH
1	231830.605	377519.089
2	231823.665	377518.547
3	231823.907	377512.237
4	231830.627	377512.117

Tag	46	
Pnts	COORDINATES	
	EAST	NORTH
1	231843.034	377599.411
2	231840.760	377596.836
3	231825.044	377590.957
4	231829.395	377572.471
5	231844.754	377578.087

Tag	49	
Pnts	COORDINATES	
	EAST	NORTH
1	231830.627	377512.117
2	231823.907	377512.237
3	231824.424	377496.773
4	231830.678	377496.786

Tag	50	
Pnts	COORDINATES	
	EAST	NORTH
1	231818.265	377519.359
2	231803.870	377519.779
3	231803.461	377514.814
4	231812.993	377518.433
5	231818.619	377514.562

Tag	51	
Pnts	COORDINATES	
	EAST	NORTH
1	231795.836	377513.196
2	231782.126	377513.600
3	231781.921	377515.633
4	231779.212	377515.649
5	231779.219	377505.634
6	231795.885	377511.944

Tag	52	
Pnts	COORDINATES	
	EAST	NORTH
1	231695.179	377475.981
2	231691.692	377476.201
3	231691.865	377478.201
4	231686.584	377478.649
5	2231686.446	377476.856
6	231671.543	377478.396
7	231665.306	377453.085
8	231670.775	377452.377
9	231672.351	377458.455
10	231681.492	377468.806
11	231694.775	377473.778

Tag	53	
Pnts	COORDINATES	
	EAST	NORTH
1	231370.595	377344.356
2	231365.701	377343.762
3	231365.069	377347.633
4	231363.247	377347.707
5	231362.819	377352.312
6	231357.059	377351.676
7	231357.288	377348.472
8	231351.492	377347.588
9	231351.925	377344.086
10	231344.207	377343.179
11	231344.461	377340.423
12	231368.072	377342.949
13	231344.461	377340.423

Tag	54	
Pnts	COORDINATES	
	EAST	NORTH
1	231369.606	377427.872
2	231345.015	377411.186
3	231290.070	377390.602
4	231290.894	377388.307
5	231306.970	377382.838
6	231362.986	377397.666
7	231368.033	377399.936
8	231372.889	377416.114

55

Pnts	COORDINATES	
	EAST	NORTH
1	230020.00	376964.378
2	230030.000	376939.563
3	230000.000	376953.394
4	230000.000	376956.751

56

Pnts	COORDINATES	
	EAST	NORTH
1	2300061.908	376858.345
2	230079.555	376811.563
3	230020.000	376787.613
4	232436.328	377821.121

وتفضلوا بقبول فائق الاحترام والتقدير

حمود مبارك شافقي
مدير ادارة نزع الملكية